

Sealed maintenance-free lead-acid batteries series DTS ASTERION brand are manufactured by AGM technology (electrolyte absorbed in glass fiber separators) and equipped with VRLA valves.

Due to a wide range of batteries and their high performance, are recommended for use in a variety of uninterruptible power supply systems, including exacting electrical appliances (submersible and circulation pumps, boilers of heating systems), emergency power supply and other electrical devices.



Battery construction

Element	Positive plate	Negative plate	Case	Lid	Valve	Terminal	Separator	Electrolyte
Material	Lead dioxide	Lead	ABS		Rubber	Copper	Fiberglass	Acid

Specifications

Nominal voltage.....12 V
 Cell.....6
 Design life.....10 years
 Nominal capacity (25°C)
 20 hours rate (6 A; 1,75 V/cell).....120 Ah
 10 hours rate (11,6 A; 1,75 V/cell).....116 Ah
 5 hours rate (19,2 A; 1,70 V/cell).....96 Ah
 Self-discharge.....3% capacity per month 20°C
 Internal resistance (25°C).....4,8 mΩ

Operating temperature range

Discharge..... -10÷40°C
 Charge..... -20÷60°C
 Storage..... -20÷60°C
 Maximum discharge current (25°C).....950A (5sec)
 Cycle mode (2,4÷2,45 V/cell)
 Max.charge current.....36 A
 Temperature correction factor.....30 mV/°C
 Standby mode (2,25÷2,3 V/cell)
 Temperature correction factor.....20 mV/°C

Application

- Uninterruptible power supply
- Back up power supply
- Space-heating system
- Renewable energy systems

Performance & characteristics

- AGM technology allows to recombine 99% of the generated gas;
- No restrictions on air transportation;
- Compliance with the UL requirements;
- Lead plates, alloyed by calcium, provide high energy density;
- Maintenance-free. Do not require distillate topping;
- Long service life;
- The battery case is made of flame-retardant ABS

Dimensions (±2mm)

Length, mm.....409
 Width, mm.....176
 Height, mm.....224
 Height over terminals, mm.....226
 Weight (±3%), kg.....32,5

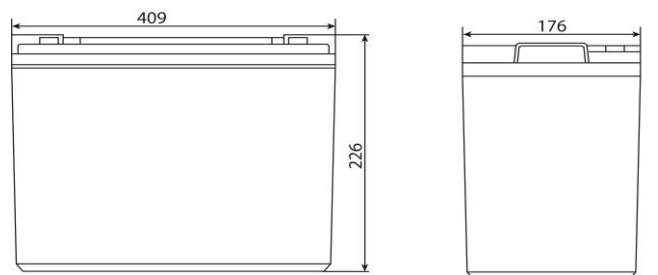

Layout B



Terminal type
Insert Ø8 mm

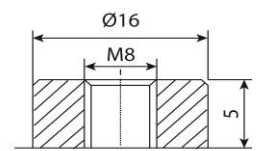
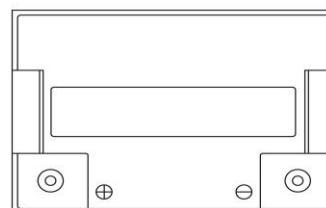
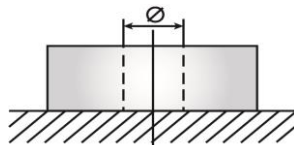

Discharge Constant Current, A (25°C)

V/cell	5 min	10 min	15 min	30 min	1 h	3 h	5 h	10 h	20 h
1,60	314	245	189	110	72,9	29,6	20,1	11,9	6,36
1,65	305	233	185	109	72,1	28,8	19,5	11,8	6,23
1,70	296	225	182	108	70,7	28,5	19,2	11,7	6,12
1,75	269	210	175	107	68,8	27,9	18,7	11,6	6,00
1,80	246	194	163	102	66,4	26,7	18,3	11,1	5,70

Discharge Constant Power, W/cell (25°C)

V/cell	5 min	10 min	15 min	30 min	1 h	3 h	5 h	10 h	20 h
1,60	542	435	346	209	135	57,7	40,3	23,7	12,6
1,65	531	422	341	208	134	56,8	39,9	23,5	12,4
1,70	525	411	337	207	133	56,3	39,2	23,1	12,2
1,75	483	387	325	204	132	55,6	38,8	23,0	12,0
1,80	445	361	304	198	128	54,7	38,5	22,3	11,4

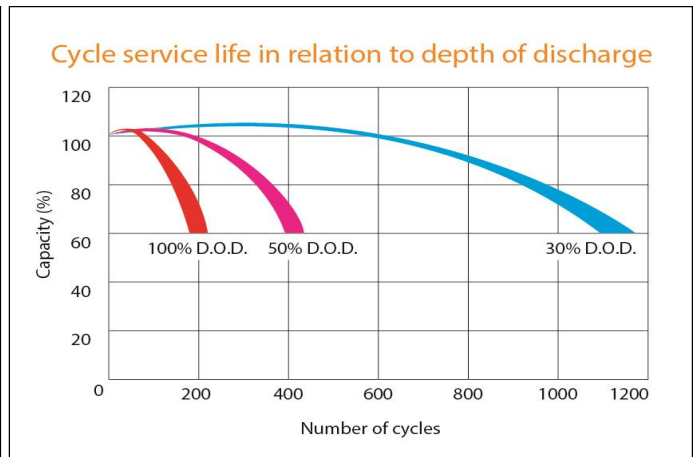
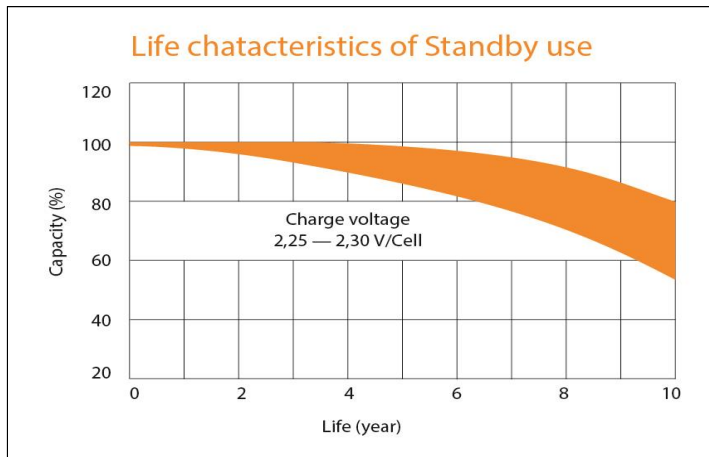
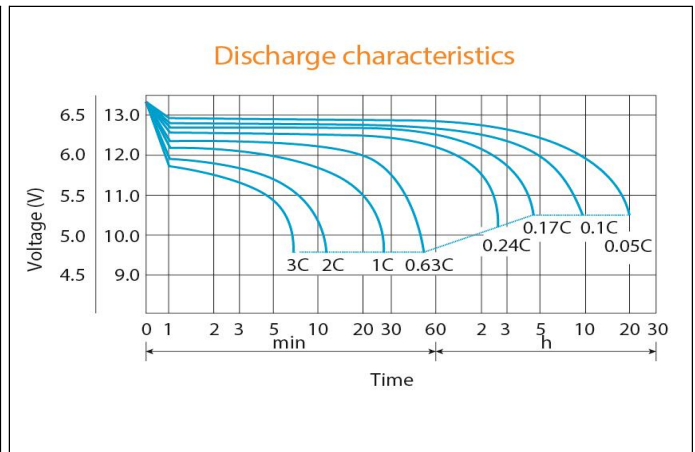
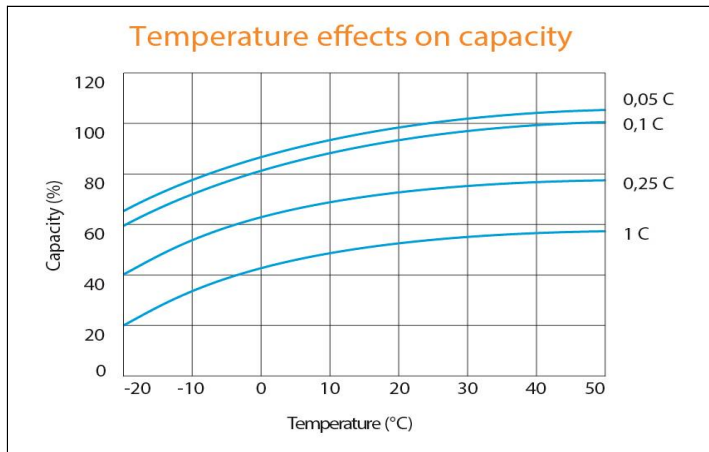

ALL DATA IS SUBJECT TO CHANGE WITHOUT NOTICE