

Sealed maintenance-free lead-acid batteries series DTM L ASTERION brand are manufactured by AGM technology (electrolyte absorbed in glass fiber separators) and equipped with VRLA valves. Series DTM L refers to a Long-Life series with a service-life up to 12 years.

Due to a wide range of batteries and their high performance, are recommended for use in a variety of uninterruptible power supply systems, including exacting electrical appliances (submersible and circulation pumps, boilers of heating systems), emergency power supply and other electrical devices.



### Battery construction

Element	Positive plate	Negative plate	Case	Lid	Valve	Terminal	Separator	Electrolyte
Material	Lead dioxide	Lead	ABS		Rubber	Copper	Fiberglass	Acid

### Specifications

Nominal voltage.....	12 V
Cell.....	6
Design life.....	10-12 years
Nominal capacity (25°C)	
10 hours rate (6,5 A; 1,8 V/cell).....	65 Ah
5 hours rate (10,8 A; 1,75 V/cell).....	54 Ah
1 hours rate (43,1 A; 1,6 V/cell).....	43,1 Ah
Self-discharge.....	3% capacity per month 25°C
Internal resistance (25°C).....	6 mΩ

### Operating temperature range

Discharge.....	-20÷60°C
Charge.....	-10÷60°C
Storage.....	-20÷60°C
Maximum discharge current (25°C).....	650A (5sec)
Cycle mode (2,35÷2,4 V/cell)	
Max.charge current.....	19,5 A
Temperature correction factor.....	30 mV/°C
Standby mode (2,25÷2,3 V/cell)	
Temperature correction factor.....	20 mV/°C

### Application

- Uninterruptable power supply
- Back up power supply
- Medical devices
- Wheelchair
- Space-heating system
- Renewable energy systems

### Performance & characteristics

- AGM technology allows to recombine 99% of the generated gas;
- No restrictions on air transportation;
- Compliance with the UL requirements;
- Lead plates, alloyed by calcium, provide high energy density;
- Maintenance-free. Do not require distillate topping;
- Long service life;
- The battery case is made of flame-retardant ABS plastic.

### Dimensions (±2mm)

Length, mm.....	350
Width, mm.....	167
Height, mm.....	179
Height over terminals, mm.....	179
Weight (±3%), kg.....	22,4

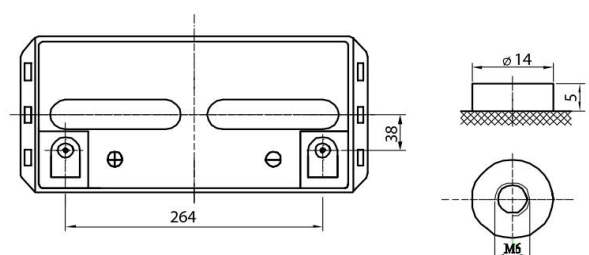
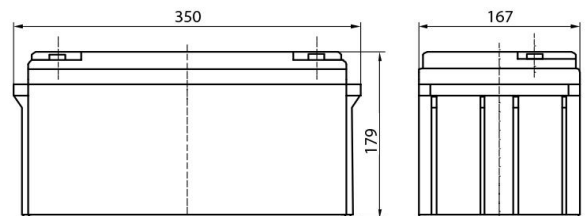

Layout  
B



Terminal type  
Insert Ø6 mm

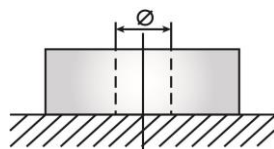

**Discharge Constant Current, A ( 25°C)**

V/cell	5 min	10 min	15 min	30 min	45 min	1 h	3 h	5 h	10 h
1,60	207	154	121	68,4	50,9	43,1	16,9	11,5	6,58
1,65	196	149	116	66,3	49,5	42,0	16,5	11,2	6,56
1,70	184	138	110	64,3	48,2	41,0	16,1	11,0	6,54
1,75	172	127	104	62,2	46,7	39,9	15,7	10,8	6,52
1,80	159	116	96,5	59,9	45,3	39,0	15,4	10,6	6,50

**Discharge Constant Power, W/cell ( 25°C)**

V/cell	5 min	10 min	15 min	30 min	45 min	1 h	3 h	5 h	10 h
1,60	368	272	197	119	90,7	78,8	33,8	22,5	12,8
1,65	347	258	193	118	89,3	77,0	33,1	22,3	12,7
1,70	325	243	190	117	87,9	75,3	32,4	21,8	12,6
1,75	304	229	186	114	85,5	73,5	31,8	21,6	12,5
1,80	292	212	177	112	84,4	72,7	31,1	21,4	12,4

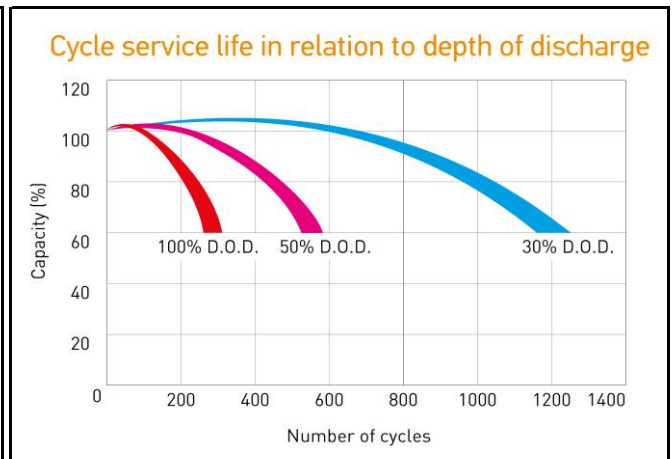
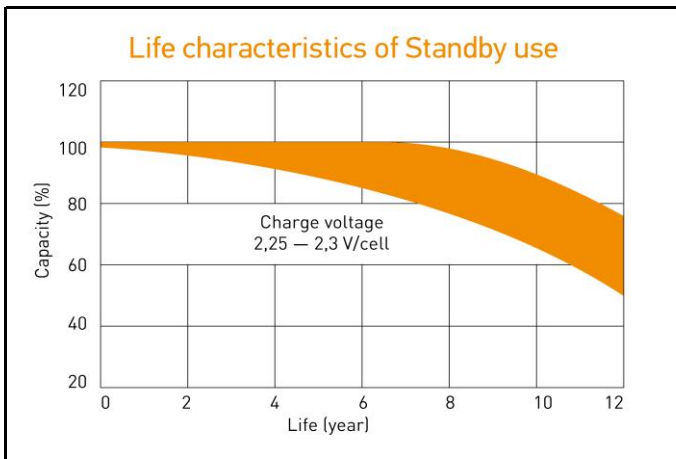
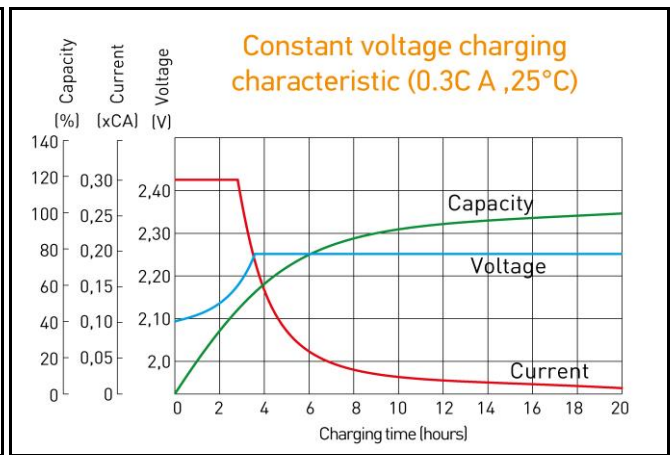
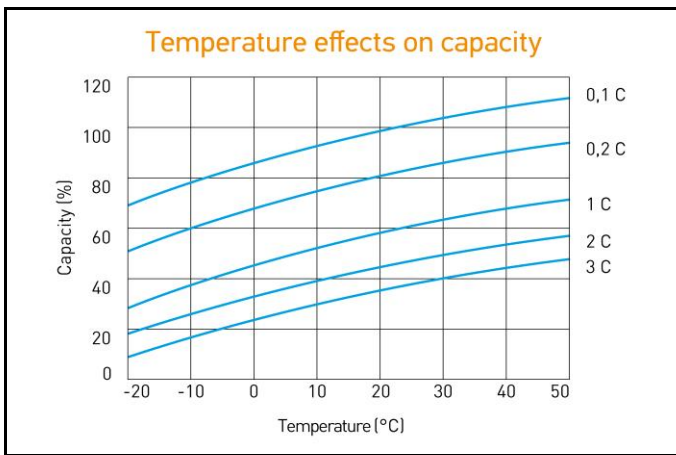

ALL DATA IS SUBJECT TO CHANGE WITHOUT NOTICE